

PIUSI E300 AC DIESEL TRANSFER PUMP

EN. High flow rate self-priming electric pump with open impeller for diesel fuel transfer applications. The check valve incorporated in the suction port prevents the siphon effect and ensures automatic repriming.

Max working pressure: 1,8 bar
 Continuous duty with 230 Vac power supply
 Cast iron impeller
 IP44 protection
 2" In/Out connections

PERFORMANCE

- Flow rate up to 550 l/min
- Continuous 230 V operation.

DIMENSIONS

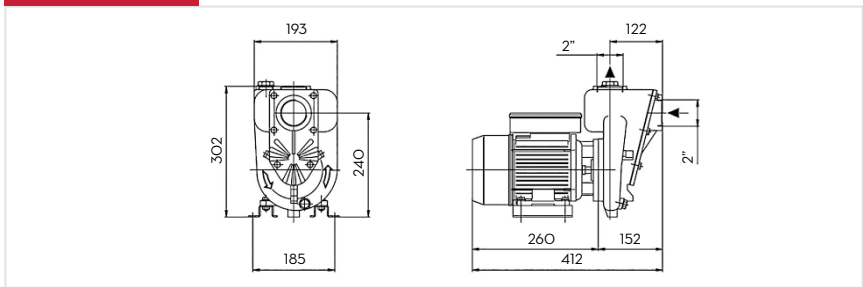

PRODUCTS' RANGE WEIGHT AND PACKAGING

Code	Weight		Packaging		
	kg	lbs	mm	inch	pcs/box
E 300					
F00321000	28	61,7	220x420x330	8,7x16,5x13	1

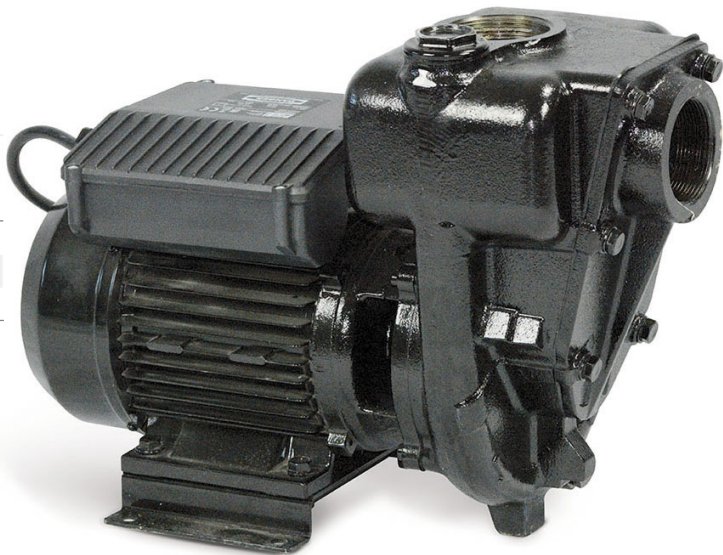

Flow-rate
up to
550 l/min
(up to 132 gpm)

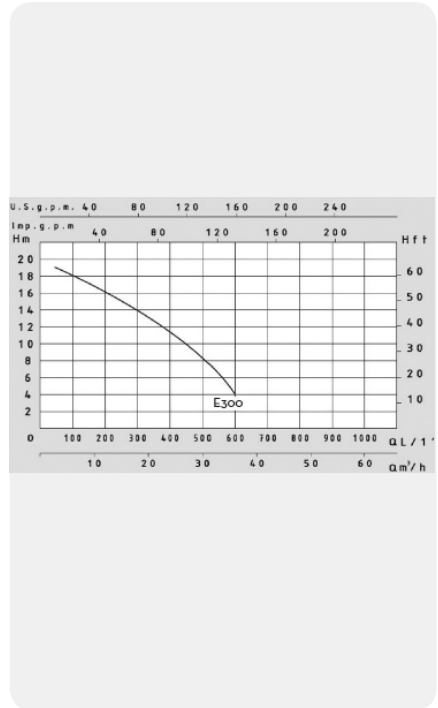
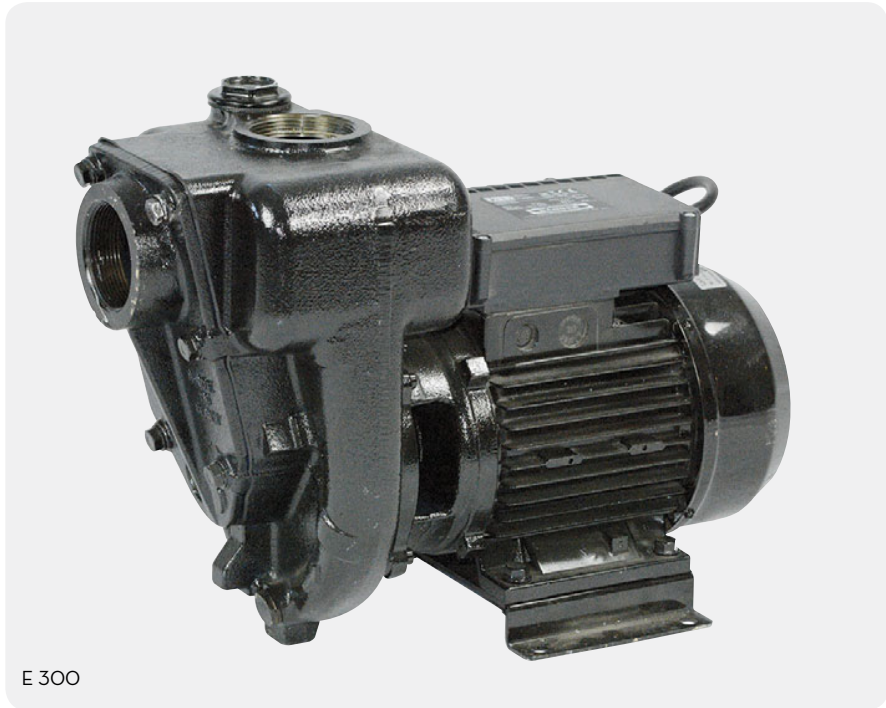

E 300

FEATURES

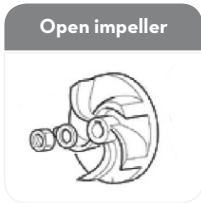

PRODUCTS' RANGE TECHNICAL DATA

Code	Description	Fluids type	Flow-rate		Voltage			rpm	Inlet Outlet BSP
			l/min	gpm	AC Volt/Hz	Power Watt	Amp. max.		
E 300									
F00321000	E 300	D	550	132	230/50	1500	9,2	2580	2"

48 Vella Drive
Sunshine West
VICTORIA 3020

Phone: (03) 9311 7822
Fax: (03) 9311 8784
E-mail: sales@liquipvictoria.com.au

