



# QM40

## FUEL METER

## ► EXTREME ACCURACY

Within  $\pm 1/2\%$  across a flow range from 2 to 40 GPM (8 to 150 L/min).

► **OVAL GEAR TECHNOLOGY**

Usually found in meters costing 10x more

► **MAGNETIC DRIVE**

## Eliminates drive shaft leaks

## NPT FITTINGS INCLUDED

to easily adapt  
to threaded 1 in.  
connections



## QUICK-FIT MODULAR

connections are designed to bolt directly to the GPI® Quick-Fit Filter Adapter, a GPI Modular Pump, or a GPRO Modular Pump.

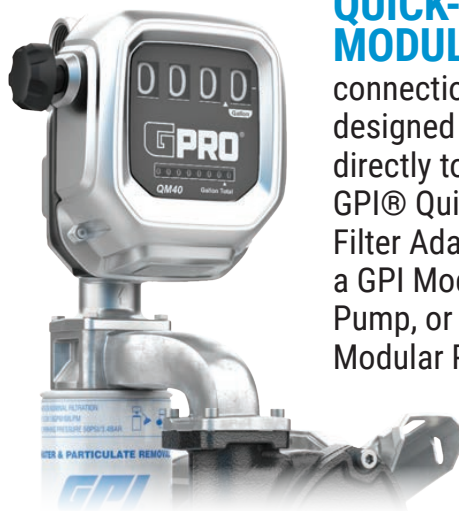

**GPRO®**



LIQUIP VICTORIA  
THE HOME OF Fuelcraft

Easy-To-Read  
Four-Digit  
Display

Twist  
Knob  
Reset



#### OVAL GEAR TECHNOLOGY & MAGNETIC DRIVE

- Eliminates drive shaft leaks

- Optional pulser accessory is compatible with most fuel management systems

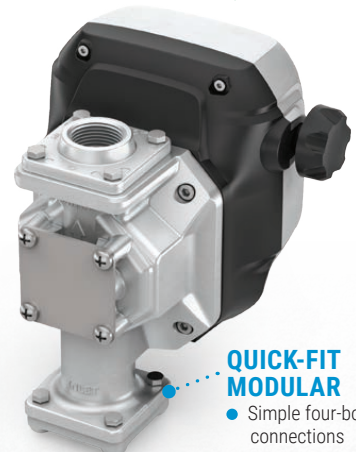

#### QUICK-FIT MODULAR

- Simple four-bolt connections

	QM40-G8N	QM40-L8N
<b>Unit of Measure</b>	U.S. Gallons	Litre
<b>Flow Range</b>	2 to 40 GPM	8 to 150 L/min
<b>Accuracy: Diesel</b>	± ½% (2 to 40 GPM) ± ¼% (15 to 35 GPM)	± ½% (8 to 150 L/min) ± ¼% (57 to 132 L/min)
<b>Accuracy: Unleaded</b>	± ½% (2 to 23 GPM w/o kit, 23 to 40 GPM w/kit*) ± ¼% (2 to 20 GPM w/o kit, 27 to 40 GPM w/kit*)	± ½% (8 to 150 L/min w/o kit, 87 to 151 L/min w/kit*) ± ¼% (8 to 75 L/min w/o kit, 120 to 151 L/min w/kit*)
<b>Maximum Batch Total</b>	999.9	9999
<b>Maximum Cumulative Total</b>	9,999,999.9	99,999,999

#### Dimensions

<b>A</b>	7.09 in.
<b>B</b>	6.63 in.
<b>C</b>	8.00 in.
<b>D</b>	9.01 in.

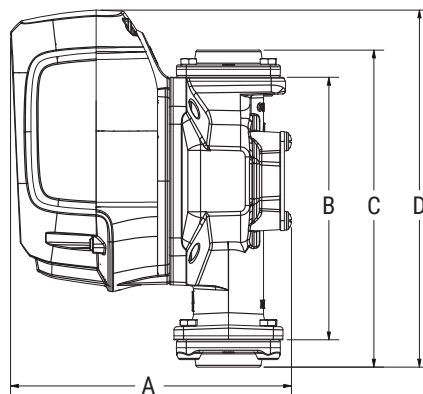

#### Ordering Information

Part No.	Model	Description
139000-01	QM40-G8N	Fuel Meter, <b>Gallon</b> , Modular Flange
139000-02	QM40-L8N	Fuel Meter, <b>Litre</b> , Modular Flange

#### ACCESSORIES

	Part No.
1 in., BSPP Fitting Kit (2 Fittings & Hardware)	139500-03
*Unleaded Fuel, Gear Kit	139500-15
Pulser Kit, 115V (ac)	126517-05
90° Adapter	139130-02

#### TECHNOLOGY

Positive Displacement Oval Gear

#### MAXIMUM WORKING PRESSURE

50 PSI (3.4 bar)

#### PRESSURE DROP (AT MAX FLOW)

Diesel: 7.0 PSI (0.5 bar)  
Unleaded: 4.5 PSI (0.3 bar)

#### OPERATING TEMPERATURE

-40° to 125° F / -40° to 52° C  
(-20° to 125° F UL)

#### COMPATIBLE FLUIDS

For use with gasoline (up to 15% alcohol blends such as E15), diesel fuel (up to 20% biodiesel blends such as B20) and kerosene

#### WETTED MATERIALS

Housing / Cover / Fittings:	Corrosion-Resistant Diecast Aluminum
Rotors:	PPS (Polyphenylene Sulfide)
Shafts / Strainer:	Stainless Steel
Seals:	NBR (Nitrile Butadiene Rubber)
Mag-Drive:	Acetal, Stainless Steel, and Neodymium (Nickel Plated)

#### INLET/OUTLET THREADS

1 in. NPT (Female)

#### WARRANTY

5 Year

©2021 Great Plains Industries, Inc. All Rights Reserved.

COM-1112 03/2021

476 Boundary Rd  
Derrimut  
VICTORIA 3026

Phone: 03 9311 7822  
E-mail: [sales@liquipvictoria.com.au](mailto:sales@liquipvictoria.com.au)

**LIQUIP VICTORIA**  
THE HOME OF **Fuelcraft**